

# B44-232 RS-232 ASCII repeater

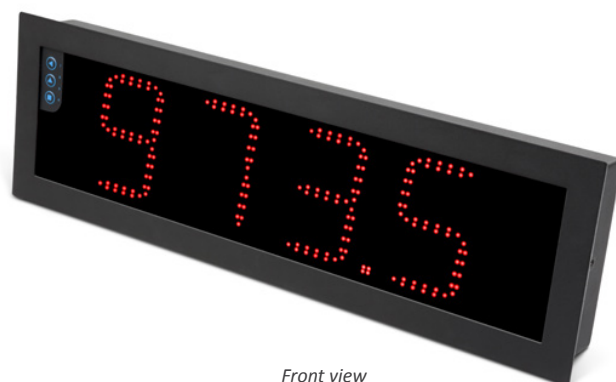

Large format meter with 4 digits and 100 mm digit height, for reading up to 50 meters for industrial applications. Repeater for ASCII protocol over RS-232 bus. Versatile and configurable instrument, with local or remote alarm control, 'watchdog' and 'bus activity' functions. Front keypad for easy access to the configuration menu and connection for remote keypad. Two universal high and low power supply options for AC and DC. Optional output and control modules for relay output, transistor output, SSR control, analog output retransmission and communications for Modbus RTU and RS-485 ASCII protocols. Sturdy metallic housing with full IP65 protection, for panel mount, wall mount or hanging mount.



Front view

## Technical specifications

<b>Reading</b>	
Digits	4
Reading	9999 / -1999
Decimal point	configurable
Led color	red or green
Digit height	100 mm
Type of digit	7 segment
Angle of vision	120°
<b>Signal</b>	
Protocol	ASCII
Bus	RS-232
Function	repeater for ASCII code
Speed	38.400 bps to 600 bps
Data format	8n1, 8e1, 8o1, 8n2
Addresses	1 to 31 ('daisy-chain' connections)
Bus terminator	not included
Watchdog	configurable from 1 to 120 seconds
Signal wire diameter	max. 0.5 mm <sup>2</sup>
<b>Outputs and configuration</b>	
Output and control options	relays, analog output, serial communications, ...
Configuration	3 button front keypad (connection for remote keypad)
<b>Power</b>	
Power 'H'	85 to 265 Vac and 120 to 370 Vdc (isolated 2500 Vac)
Power 'L'	11 to 36 Vdc (isolated 1500 Vdc)
Consumption	<5.25 W (meter only) <6.75 W (meter with options)
Power wire diameter	max. 2.5 mm <sup>2</sup>
<b>Mechanical</b>	
Housing	metallic (textured black painted iron)
Front filter	methacrylate
IP protection	full IP65 housing
Connections	cable gland output internal plug-in screw terminals
Weight	<2500 grams
Mounting	panel, wall, hanging
Front size	542 x 166 mm
Panel cut-out	524 x 148 mm
Deep	80 mm (including terminals)
Operating temperature	0 to 50 °C
Storage temperature	-20 to 70 °C

## Order reference

Format	Model	Power	Color	Option 1	Option 2	Option 3	Custom
B44	232	H	R				
		-H (85-265 Vac and 120-370 Vdc) -L (11-36 Vdc)	-R (red led) -G (green led)	-R1 (1 relay output) -AO (analog output) -RTU (Modbus RTU) -S4 (RS-485) -S2 (RS-232) -T1 (1 transistor output) -SSR (1 SSR control output) -0 (empty)			

\* Option 3 available with formats B26 and B46



Rear view

**45**  
YEARS

1969-2014

**Q**

ISO 9001  
Certified Quality

**CE**

EN-61010-1  
Security

**CE**

EN-61326-1  
Electromagnetic C.

**5**  
YEARS

Extended Warranty

**Amplicon.com**

**IT and Instrumentation for industry**

**Amplicon**

Sales: +44 (0) 1273 570 220 Website: [www.amplicon.com](http://www.amplicon.com) Email: [sales@amplicon.com](mailto:sales@amplicon.com)

## Output and control options

Format	Model	Power	Color	Option 1	Option 2	Option 3	Custom
B44	232	H	R				

	Function	Installable options	Isolation
R1	1 relay output	2	yes
T1	1 transistor output	2	yes
SSR	1 control for SSR relay	2	yes
AO	1 analog output	2	yes
RTU	1 Modbus RTU port	2	yes
S4	1 RS-485 port	2	yes
S2	1 RS-232 port	2	yes
Option 3 available with formats B26 and B46			

## Mounting options

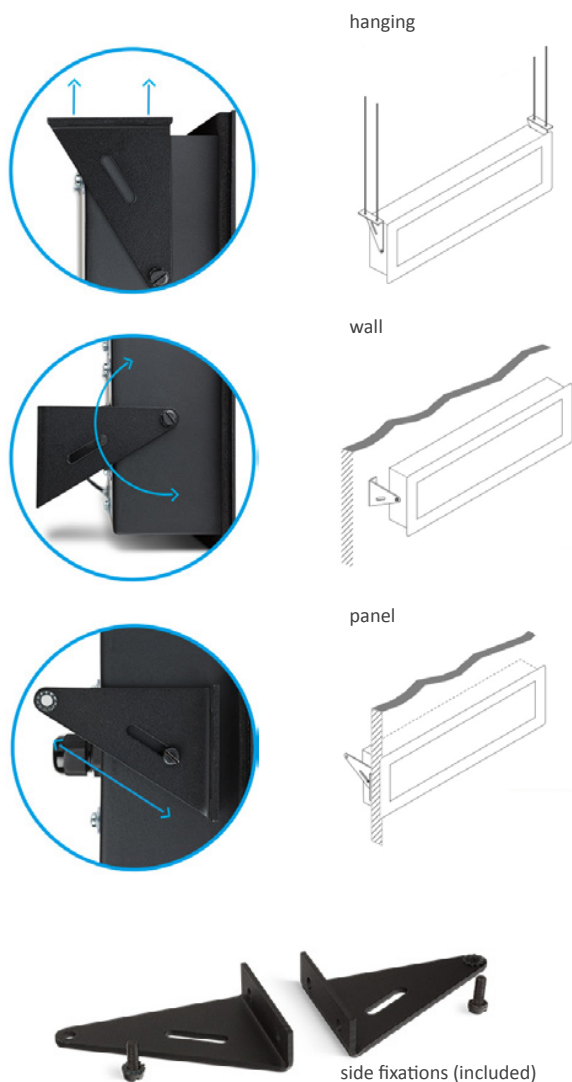

## Functions included

Remote or local alarms . . . . . 'Full slave' mode allows for remote control of the alarms by writing to registers or coils. 'Process slave' mode allows for local control of alarms, based on local alarm configuration and actual display value.

'Text' mode . . . . . in 'Text' mode, ASCII characters received are not translated to number, but are directly displayed as 7 segment characters. Alphanumeric characters are allowed and will be translated to 7 segment. Alarms are controlled remotely.

'Watchdog' function . . . . . generates error after predefined time without communication with the master. Alarm can be linked to the watchdog function.

'Bus activity' . . . . . function detects electrical activity on the bus. Useful for troubleshooting.

'Fast access' menu . . . . . a single press on the front keypad gives access to the instrument address or alarm setpoint.

'On power-up' function . . . . . protects systems at cold start-up.

Brightness . . . . . 5 levels of brightness intensity.

Password . . . . . blocks access to configuration menu.

## Dimensions

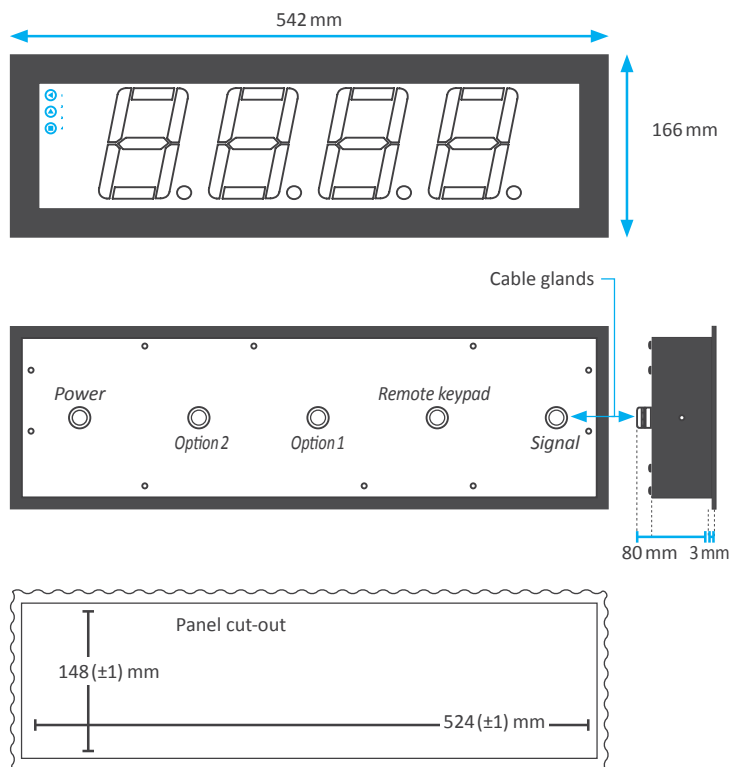

45  
YEARS

1969-2014

Q

ISO 9001

Certified Quality

CE

EN-61010-1

Security

CE

EN-61326-1

Electromagnetic C.

5  
YEARS

Extended Warranty

## Connections

Internal structure for a B26 instrument

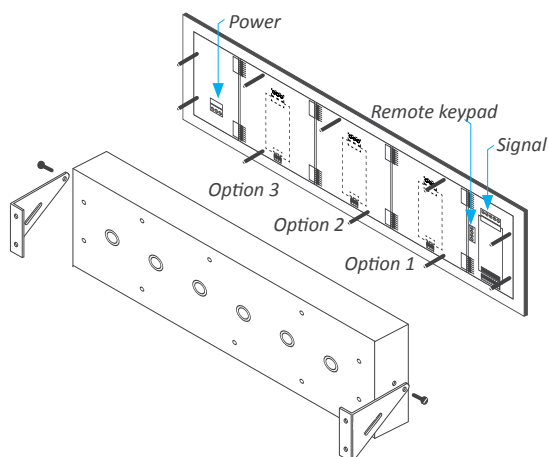

Power connections

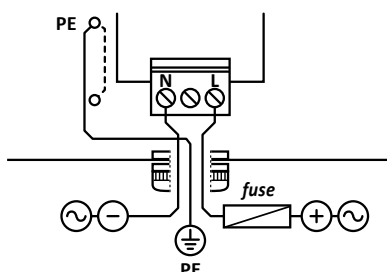

Signal connections

(Tx1, Rx1 for normal RS-232 connection. Tx2 Rx2 for 'daisy chain')

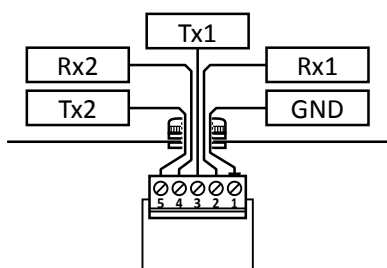

Connections for remote keypad

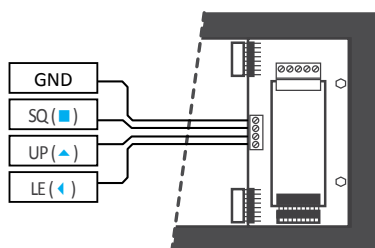

## Example of application with control

A manufacturing line is controlled from a centralized PLC or SCADA. The PLC receives and manages all the information related to process control. Some information is critical to the local operators, and it is communicated through the ASCII protocol repeaters. Critical information depends on each application, for example, production rates, total stop times, trouble codes, etc.

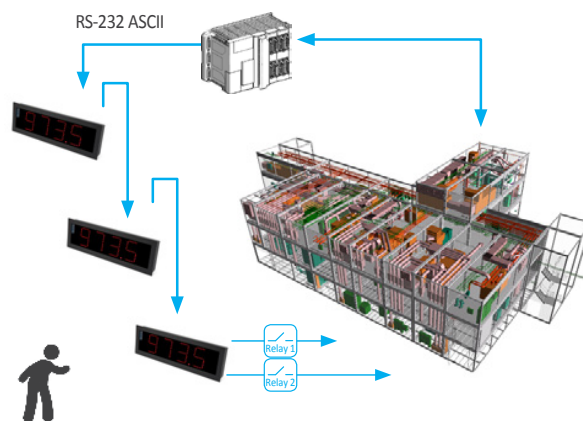

## One measure, multiple information points

The large format meters from Series B can measure a wide variety of signals, and can integrate multiple output and control options. Option 'S4' for communications can be configured to transmit the measure directly to remote information points.

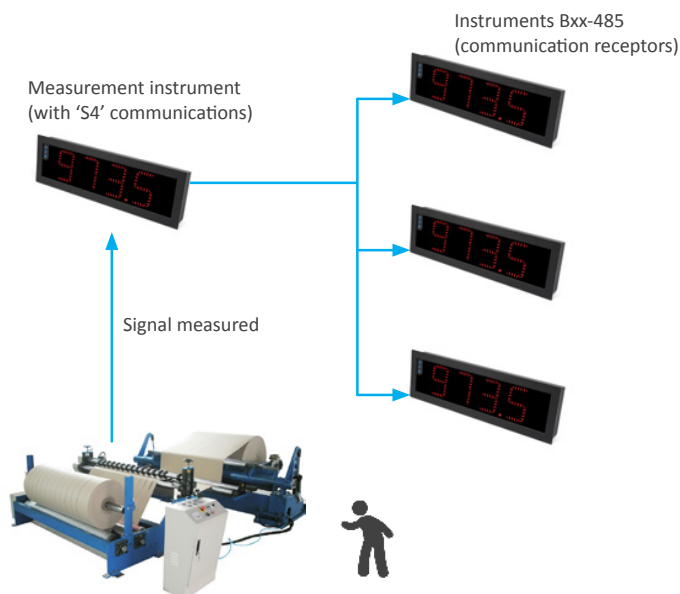

45  
YEARS

1969-2014

Q

ISO 9001  
Certified Quality

CE

EN-61010-1  
Security

CE

EN-61326-1  
Electromagnetic C.

5  
YEARS

Extended Warranty

## Other options

**Red color**

JPG

Red leds

**Green color**

JPG

Green leds

**White color**

JPG

White leds

**Cable output**

JPG

Preinstalled cable, 2 meters

## Others formats within the Series B

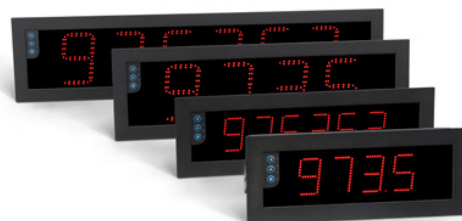

	Digit height	Digits	Reading distance
<b>Format B24</b>	60 mm	4	up to 25 meters
<b>Format B26</b>	60 mm	6	up to 25 meters
<b>Format B44</b>	100 mm	4	up to 50 meters
<b>Format B46</b>	100 mm	6	up to 50 meters

## Accessories

**RKB**

Remote keypad

**IPB24**

JPG

IP65 protection for the B24 panel junction

**IPB26**

JPG

IP65 protection for the B26 panel junction

**IPB44**

JPG

IP65 protection for the B44 panel junction

**IPB46**

JPG

IP65 protection for the B46 panel junction

## Other RS-232 ASCII repeaters

### Series M

4, 5 and 6 digits

digit height ..... 14 mm  
 color ..... red, green  
 vision ..... 5 meters  
 size ..... 96 x 48 mm

DIGITAL PANEL METER  
**SERIES M**  
 Full Signal Ranges Available



### Series K

Further view

digit height ..... 20 mm  
 color ..... red  
 vision ..... 8 meters  
 size ..... 96 x 48 mm

DIGITAL PANEL METERS  
**SERIES K**  
 20 mm Digit Size



### Series S

Compact size

digit height ..... 14 mm  
 color ..... red, green  
 vision ..... 5 meters  
 size ..... 72 x 36 mm

DIGITAL PANEL METERS  
**SERIES S**  
 Compact Size 72x36 mm



**45**  
YEARS

1969-2014

**Q**

ISO 9001  
Certified Quality

**CE**

EN-61010-1  
Security

**CE**

EN-61326-1  
Electromagnetic C.

**5**  
YEARS

Extended Warranty